

# OPTI-GRO™

## Installation Best Practices

Opti-Gro Units are designed to accelerated growth, advance shoot lignification and reduce mortality in newly planted table grape and wine grape vines. These highly effective plant growth chambers provide a photo selective light environment coupled with a protective micro-climate around the young vine, resulting in enhanced growth and development, protection from environmental stresses and natural vine training. As a result, newly planted vineyards and replacement vines begin producing and reach full production years earlier. Opti-Gro units significantly reduce labor costs associated with vine training, pruning and maintenance – the Unit does most of the work.

Opti-Gro Units are durable, versatile and built to last a minimum of ten (10) years. They are easy to install, dismantle, and store. The modular system can be configured for optimal performance across a wide range of climates, weather conditions and trellis designs. Unit height and level of ventilation can easily be modified for a variety of farming environments, trellising and drip irrigation systems (Figure 1).

### NOTES:

Perform all normally scheduled sprays, irrigation/ fertigation and amendments. No need to remove Opti-Gro Units during scheduled spraying.



Figure 1: Modular system adapts to different heights of trellising system

## What You Need for a 5' Opti-Gro

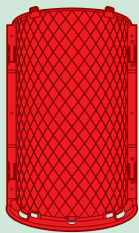

Base Chamber (x3)



Tending Chamber (x1)

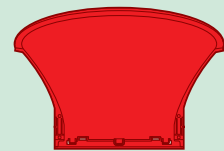

Solar Funnel (x2)

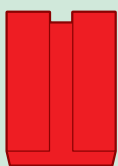

Bracket (x10)

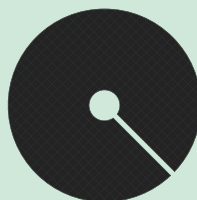

Weed Mat (x1)



**Opti-Harvest**

Better Light Makes Better Fruit™

[opti-harvest.com](http://opti-harvest.com)

833-TRY-OPTI

# OPTI-GRO™

## Assembly and Securing Units

Install Opti-Gro immediately after planting or field grafting

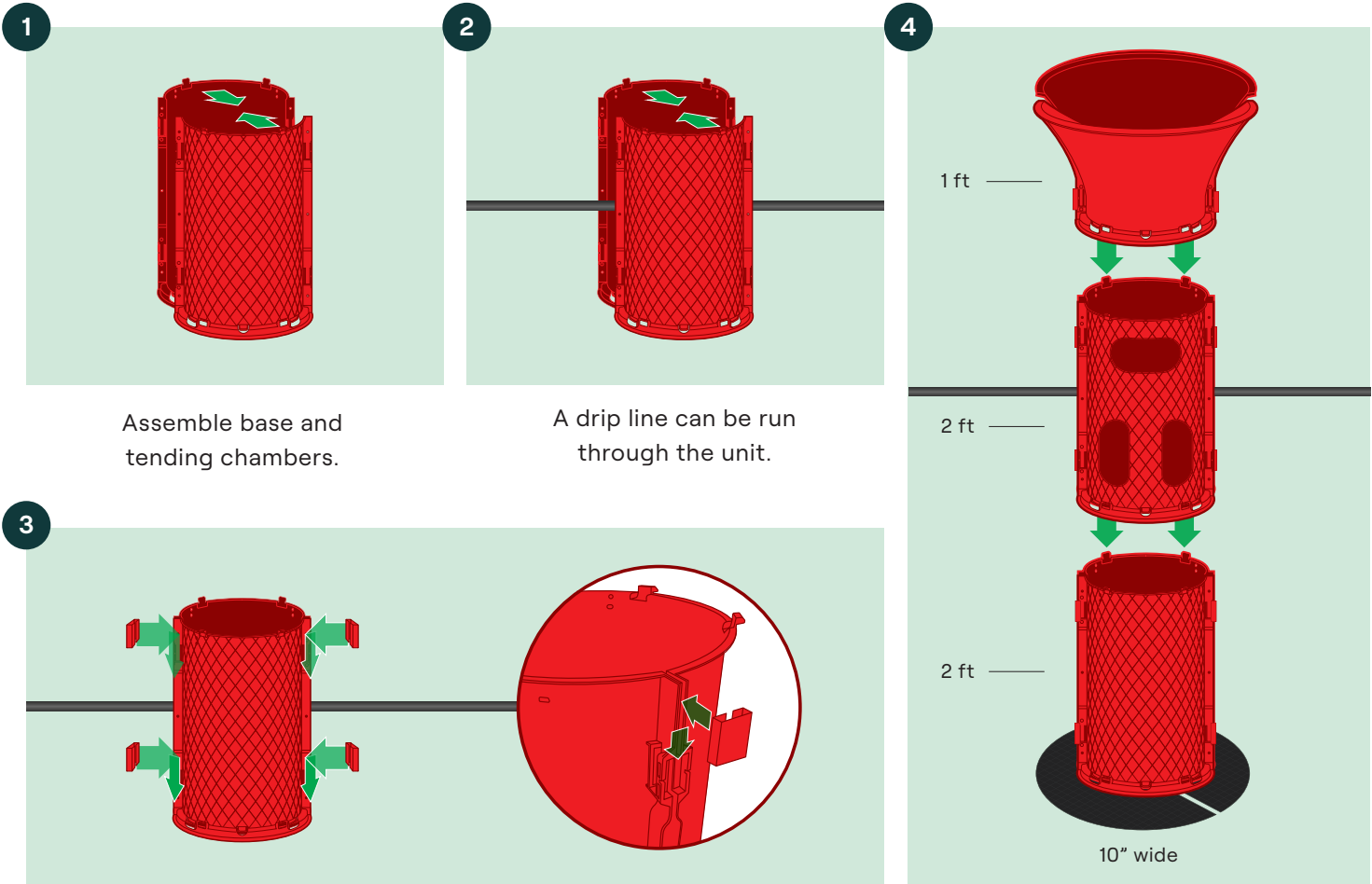

Assemble base and tending chambers.

A drip line can be run through the unit.

Attach brackets to secure units.  
Assembled chambers lock to one another.

Securing Units: Assemble Opti-Gro units over suspended irrigation lines, and pre-existing trellis wires using the various openings in the Units.

## Vine Management

### Winter pruning

Open the Opti-Gro unit and prune the lateral shoots, leaving the main shoot and an insurance shoot. Tip the shoots right below point of lignification or just below topmost wire of trellis system. Tie shoot to the stake and reset Opti-Gro unit back on vine.

### Spring/Summer:

When the main shoot is long, create the cordons and quads by tying to the wire. **DO NOT** remove lateral shoots as they add to the leaf area supporting upward growth of the main shoot. Lateral shoots may be tipped to reduce the push of the lateral shoots

## Opti-Gro removal and storage

Dismantle Opti-Gro Units by removing clips, sections and weed mat. Remove shoots leaving only the main shoot. Units can be reinstalled on newly planted plots or kept in storage until needed..



**Opti-Harvest**

Better Light Makes Better Fruit™

opti-harvest.com  
833-TRY-OPTI